



# PUMA ULTRA & XLE LITE

BY PALOMINO – SINCE 1968





## GREAT TIMES COME IN SMALL PACKAGES

Pack-up for a quick weekend getaway, or a trip to your favorite vacation spot. Wake up to an amazing view in the **16 BHx** – there's large front and side windows. Stow away extra gear and supplies in handy overhead cabinets and under bed storage. Preparing a quick meal is a breeze with generous, long-lasting, stain and abrasion resistant surf(x)<sup>®</sup> 3D, one-piece, seamless countertops. This galley includes a single bowl sink with high-rise faucet, a stainless steel 11 cu. ft., 12V residential refrigerator and a two-burner gas cook top. Easy to clean Beauflor<sup>®</sup> flooring maintains its like new appearance.

**PUMA** **ULTRA**  
**LITE**  
TRAVEL TRAILERS & TOY HAULERS



Puma's Ultra Lite single axle, 7' wide models come standard with large front windows. These lighter weight, eco-friendly models offer great fuel efficiency, and can be towed by crossover vehicles and smaller SUVs.

## PUMA ULTRA LITE PACKAGES

### ULTRA LITE PACKAGE (Required)

- Aluminum Solid Double Step
- Outside Shower
- Spare Tire & Carrier
- 13,500 BTU Non-Ducted A/C
- Power Tongue Jack
- AM/FM/Bluetooth Stereo

- 55 Amp Converter
- Front Diamond Plate
- Electric Awning
- Stainless Steel Microwave
- Stainless Range Hood
- 2 Exterior Speakers
- Back-up Camera Prep

### ULTRA LEADER PACKAGE (Required)

- 11 Cu. Ft. 12V Residential Refrigerator
- Tub Surround
- Bedspread with Pillows
- Solar Prep
- WiFi Prep
- TV Antenna
- TV Hook-up

- Cable Hook-up
- Tinted Safety Glass Windows
- Night Shades
- Super Lube Axle
- Front & Rear Stabilizer Jacks
- Beauflor Linoleum
- Bath Skylight
- 6 Gal. Gas/Electric DSI Water Heater
- LED Lighting Throughout

## PUMA ULTRA LITE STANDARD FEATURES

### EXTERIOR

- Friction Hinged Radius Entry Doors
- Smooth, Radius Front Metal with Diamond Plate
- Large Front Frameless Window (Most models)
- Powder Coated Frames
- Clamp Ring Windows
- Pass-Thru Storage (Where applicable)
- AlphaPly Roofing Membrane (Limited lifetime warranty)
- Rain Gutters with Large Down Spouts
- Radius Baggage Doors

- Darco Wrapped Underbelly
- 5/8" Araucopy Tongue and Groove Plywood Floor Decking (25 Year manufacturer's limited warranty)
- 2" x 2" Flush Floor Joists on 12" Centers
- 1-30 Lb. Gas Bottle
- Schwintek Slide System with Manual Override (Small models)
- Clamp Ring Luggage Doors

### INTERIOR

- 78" Interior Height
- 20,000 BTU Furnace
- USB Charging Ports
- Decorative Kitchen Backsplash

- Spice Rack (Kitchen)
- Divided Silverware Drawer
- Nickel Finish, Single Control Gooseneck Kitchen Faucet
- 30 Amp Converter with Battery Charger
- Jack Knife Sofa
- Power Vent in Bath
- 27" x 27" Radius Shower with Door\*
- 24" x 40" Tub/Shower\*
- 12V Shower LED Light
- 60" x 74" Queen Beds (Most models)
- Shirt Closet in Front Bedrooms\*
- Upgraded Soft Teddy Bear

- Bunk Mats
- Two Interior Decors
- Contemporary Hardware, Light & Bath Fixtures
- Dinette Seat Bases with Storage
- Residential Carpet
- Designer Window Treatments (Living room)

### SAFETY FEATURES

- CO Detector
- LP Leak Detector
- Fire Extinguisher
- Smoke Detector

\*Available on select models.



Convert the dinette in the 16 BHX to a comfortable sleeping area. There's extra storage under the seats to keep things tidy. This stylish, well lit decor includes energy efficient LED lighting, convenient USB charging ports, contemporary black hardware throughout and privacy enhancing night shades.

## PUMA ULTRA LITES

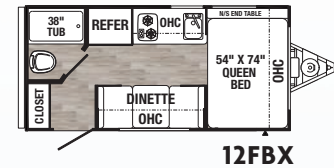

12FBX

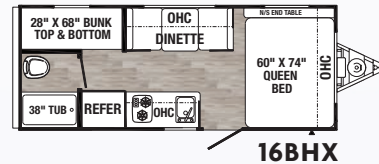

16BHX

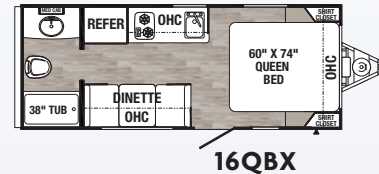

16QBQ

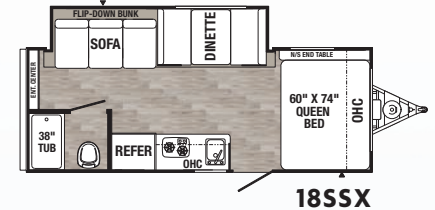

18SSX

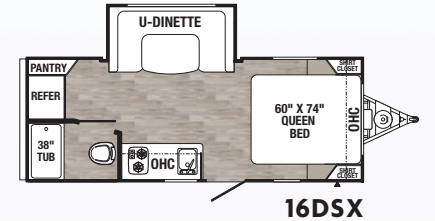

16DSX

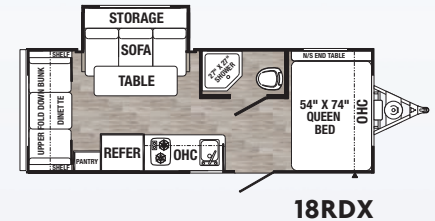

18RDX

## PUMA ULTRA LITE TOY HAULER

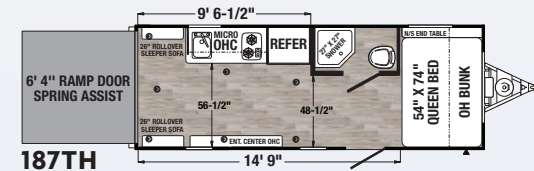

187TH

## PUMA ULTRA LITES

MODEL	12FBX	16BHX	16QBQ	18SSX	16DSX	18RDX	187TH
Hitch Weight (lbs)	410	370	380	425	415	455	535
Axle Weight (lbs)	2400	2745	2715	3620	3270	3315	2965
UVW (lbs)	2839	3144	3124	4074	3714	3799	3529
GVWR (lbs)	3910	3870	3880	4825	4815	4855	4935
Cargo Capacity (lbs)	1070	725	755	750	1100	1055	1406
Exterior Length	18' 6"	21' 6"	21' 6"	22' 9"	22' 6"	23' 2"	22' 9"
Exterior Height w/AC	9' 11"	9' 11"	9' 11"	10' 1"	10' 1"	10' 1"	10' 1"
Exterior Width	84"	84"	84"	84"	84"	84"	84"
Fresh Water Cap. (gal)	34	34	34	34	34	34	34
Black Water Cap. (gal)	30	30	30	30	30	30	30
Grey Water Cap. (gal)	30	30	30	30	30	30	30
Tire Size (in)	14"	14"	14"	15"	15"	15"	15"
Awning Size (ft) OPT.	10'	12'	13'	14'	14'	14'	14'

Refer to back cover for chart definitions.

Check us out at: <https://palominorv.com/travel-trailers/puma-ultra-lite>



Smooth, aerodynamic radius front with diamond plate, and two-tone exterior metal add curb appeal. Front windshield shown.

# PUMA XLE LITE

## TRAVEL TRAILERS

### LIGHT WEIGHT CONSTRUCTION

Construction features include solid I-beam frames, strong, resilient Araucopy flooring underlayment, and AlphaPly roofing membrane. Smaller slide models offer the Schwintek slide system, while larger models use the rack and pinion slide system. Both of these reliable systems have manual override and provide superior sealing.

Start your camping adventures right with a Puma XLE Lite! **30DBSC** is a family friendly bunkhouse that sleeps up to ten, with LED lighting, convenient USB charging ports, a large pantry and contemporary black hardware throughout.



### PUMA XLE LITE PACKAGES

#### VALUE LEADER PACKAGE (Required)

- Tub Surround
- Bedsprad with Pillows
- TV Antenna with Cable Hook-up
- Tinted Safety Glass Windows
- Super Lube Axles
- Front & Rear Stabilizer Jacks
- Beauflor Linoleum
- Bath Skylight

- LED Lighting Throughout
- Bedroom TV Hook-up
- Back-up Camera Prep
- WiFi Prep
- Solar Prep

#### ELITE PACKAGE (Required)

- Electric Awning
- 17" Oven & Range Hood
- Stainless Steel Microwave

- AM/FM/Bluetooth Stereo
- 2 Exterior Speakers
- Outside Shower
- Spare Tire
- Front Diamond Plate
- 13,500 BTU Ducted A/C
- 6 Gal. Gas/Electric Water Heater
- Night Shades
- Aluminum Solid Steps
- 11 Cu. Ft. Residential Refrigerator

#### ELECTRIC POWER PACKAGE (Optional)

- 4 Electric Stabilizer Jacks • 3500 lb Electric Tongue Jack

### PUMA XLE LITE STANDARD FEATURES

#### EXTERIOR

- Friction Hinged Radius Entry Doors
- Smooth, Radius Front Metal with Diamond Plate
- Large Front Frameless Window (Most models)
- Powder Coated Frames
- Clamp Ring Windows
- Pass-Thru Storage (Where applicable)
- AlphaPly Roofing Membrane (Limited lifetime warranty)
- Rain Gutters with Large Drop Spouts
- ABS Automotive Style Fender Skirts
- Radius Baggage Doors
- Darco Wrapped Underbelly
- 5/8" Araucopy Tongue and Groove Plywood Floor Decking (25 Year mfg. limited warranty)
- 2" x 3" Flush Floor Joists on 12" Centers
- 2-20 Lb. Gas Bottles
- Rack & Pinion Electric Slide

- System with Manual Override (Large models)
- Schwintek Slide System with Manual Override (Small models)
- Clamp Ring Luggage Doors

#### INTERIOR

- 80" Interior Height (Large models)
- 78" Interior Height (Small models)
- USB Charging Ports
- Floor Ducted Heat (Most models)
- Decorative Kitchen Backsplash
- Spice Rack (Kitchen)
- Divided Silverware Drawer
- Nickel Finish, Single Control Gooseneck Kitchen Faucet
- Undermount Stainless Steel Sink
- Glass Range Cover
- Built-in Knife Rack
- 55 Amp Converter with Battery Charger
- Jack Knife Sofa with Pull-down

- Center Drink Tray – Storage Underneath (Most models)

- Wood Medicine Cabinet with Mirrored Door
- Power Vent in Bath
- Glass Shower Door\*
- 12V Shower LED Light
- 60" x 74" Queen Beds
- Upgraded Soft Teddy Bear Bunk Mats
- Shirt Closet in Front Bedrooms
- Two Interior Decors
- Contemporary Black Hardware
- Square Dinette Seat Bases with Storage
- Residential Carpet
- Designer Window Treatments (Living room)

#### SAFETY FEATURES

- CO Detector
- LP Leak Detector
- Fire Extinguisher
- Smoke Detector

\*Available on select models.

Check us out at: <https://palominorv.com/travel-trailers/puma-xle-lite>



**30DBSC** Get away and enjoy vacation time in style. Puma XLE Lite offers homestyle conveniences at your fingertips. Access large pot and pan storage from both sides of this contemporary L-shaped galley. The 17" oven with LED backlit controls and a glass range cover includes a 3-burner stove with a decorative backsplash. Kitchen features include built-in spice storage, an undermount sink with cover, a nickel finish, single lever gooseneck faucet, Surf(x)® 3D, one-piece, seamless countertops and contemporary black hardware. AM/FM Bluetooth Stereo, WiFi and solar prep are all included. Optional TV shown.



**30DBSC** This space saving walk-around queen bed has easy access to underbed storage. Pack the large, mirrored wardrobes for a long adventure.

**30DBSC** Kids and guests appreciate this private bunk house. It has built-in bunk ladder, shirt wardrobe, plus standard TV prep for movies and video games. Bunks are rated for 300 lbs. and include USB charging ports.



## EXPERIENCE ULTRA EASY LIVING



Settle in for a great time. The versatile **30DBSC's** 84" radius U-dinette converts to a comfortable sleeping area. Spacious sliding windows let in plenty of natural light and fresh air. Spread out and relax! The sofa has storage underneath and features a handy flip-down drink tray.



## PUMA XLE LITES



### LIGHTEN UP

Puma XLE Lite offers a broad range of value added light weight floorplans, loaded with convenience features. They're a perfect fit for couples and families for weekend getaways. Our well-planned packages offer a popular selection of user-friendly amenities that RV enthusiasts prefer. Interiors include durable Beauflor tile pattern and efficient LED lighting throughout.

*The half-ton towable 23BHC comfortably fits your family and friends with open concept living and plenty of sleeping space. The bath has a large 32" x 40" shower, power vent, skylight, a wood medicine cabinet with mirrored door plus, an LED motion sensor light.*



*These large storage cabinets and drawers are the perfect place to stash gear and extras, keeping living space clutter-free.*

## PUMA XLE LITES

MODEL	20MBC	20RLC	21FBC	22FKC	22RBC	23BHC	24FBSC	25BHSC	25RBSC	27RBQC	30DBSC	31BHSC
Hitch Weight (lbs)	450	600	460	700	435	600	556	650	590	687	754	912
Axle Weight (lbs)	3970	3570	4092	4715	3770	4470	4252	5340	5070	5208	5546	6996
UVW (lbs)	4458	4208	4590	5453	4243	5108	4808	6028	5698	5933	6338	7946
GVWR (lbs)	6000	5708	6200	6953	5800	6608	6500	7528	7300	7687	8000	9600
Cargo Capacity (lbs)	1542	1500	1610	1500	1557	1500	1654	1500	1602	1754	1662	1654
Exterior Length	26'	24' 10"	25' 5"	26'	26'	30' 1"	27' 6"	30' 5"	29' 8"	33' 2"	33' 7"	35' 6"
Exterior Height w/AC	10' 2"	10' 2"	10' 2"	10' 2"	10' 2"	10' 2"	10' 2"	11' 1"	11' 1"	11' 1"	11' 1"	11' 1"
Exterior Width	96"	96"	96"	96"	96"	96"	96"	96"	96"	96"	96"	96"
Fresh Water Cap. (gal)	43	43	43	43	43	43	43	43	43	43	43	43
Black Water Cap. (gal)	35	35	35	30	35	35	35	35	35	30	35	30
Grey Water Cap. (gal)	35	30	35	65	35	69	35	70	30	65	35	35
Tire Size (in)	14"	14"	14"	14"	14"	14"	14"	15"	15"	15"	15"	15"
Awning Size (ft) OPT.	14'	10'	14'	18'	10'	19'	16'	19'	18'	21'	18'	21'

Refer to back cover for chart definitions.

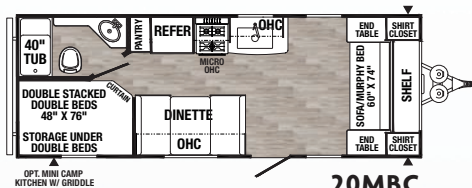

20MBC

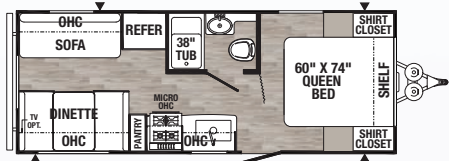

20RLC

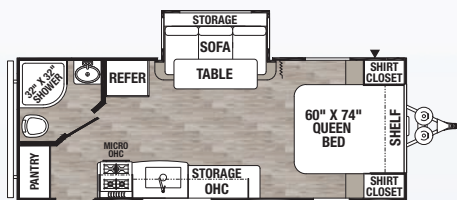

21FBC

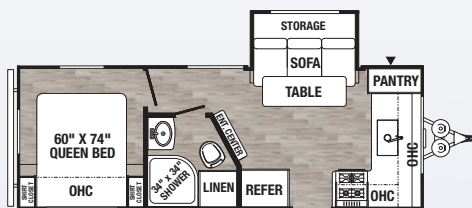

22FKC

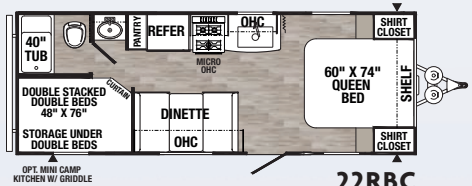

22RBC

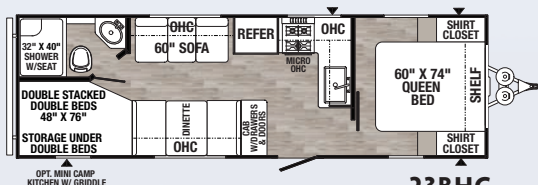

23BHC

## XLE LITE TRAVEL TRAILER OPTIONS

Available on select models.

### OUTSIDE KITCHEN OPTION W/ GRIDDLE

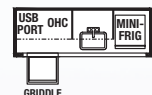

30DBSC • 31BHSC  
27TSB

### MINI CAMP KITCHEN OPTION W/ GRIDDLE

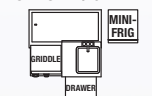

20MBC • 22RBC  
23BHC • 25BHSC  
27RBQC • 30DBSC  
31BHSC

### MICRO OUTSIDE KITCHEN OPTION W/ GRIDDLE



22FKC

### FREE STANDING TABLE & CHAIRS OPTION

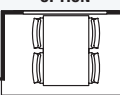

22FKC

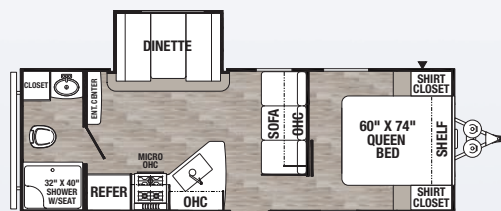

24FBS

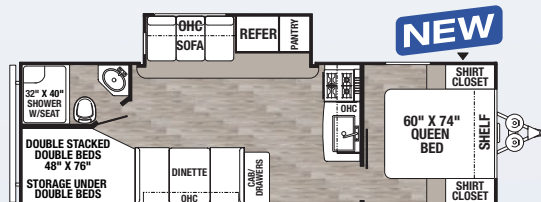

25BHS

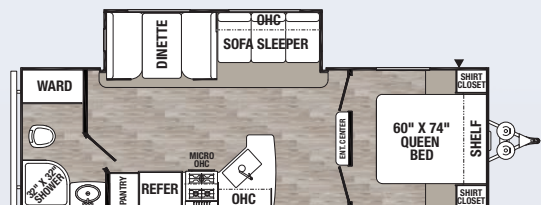

25RBS

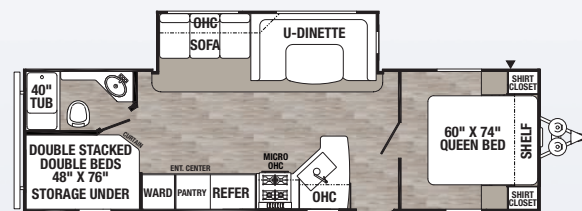

27RBQ

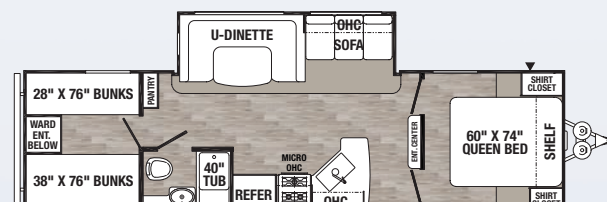

30DBS

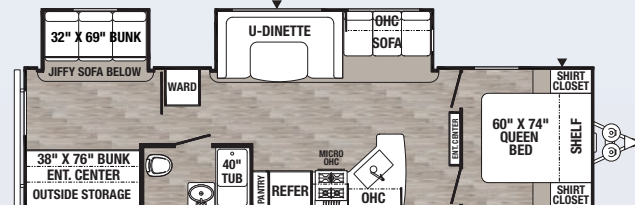

31BHS

**23BHC** Puma XLE Lites are great for kicking back at game time, stream your music throughout. Night shades enhance privacy. Shown with Cafe Latte decor.



# PUMA XLE LITE

## STANDARD FEATURES & OPTIONS

Puma XLE Lite offers a broad range of value added convenience features. Our well-planned packages include a popular selection of user-friendly amenities that RV enthusiasts prefer.



- Thickest RV roof membrane available
- Won't crack or shrink over time
- Highest UV resistance
- Mold and mildew resistant
- Limited lifetime warranty

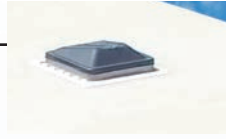

11 Cu. ft. 12V double door refrigerator/freezer



3-Burner stove and 17" oven with backlit LED controls and an easy to clean decorative backsplash



Queen bed with designer bedspread, large shirt wardrobes and shelving.



Convenient USB charging outlets throughout

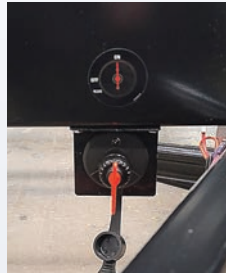

Seafo battery isolator switch prevents power drain. Operates by removable key



Friction hinge entry door with window and kick plate



Hot and cold outside shower reduces tracking dirt indoors

## DECOR OPTIONS Puma XLE Lite offers two contemporary decor packages.

### CAFE LATTE

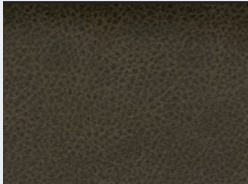

### SLATE



### BEDROOM



### FLOORING



Beauflor® tile linoleum with a 7-year cold crack warranty



Easy to lift under bed storage with finished edge trim is ideal for linens and big items



The sofa has a flip-down drink tray and plenty of storage underneath



Decorative wall art with convenient coat hooks



Stainless steel undermount sink with roll-up cover and single lever gooseneck faucet

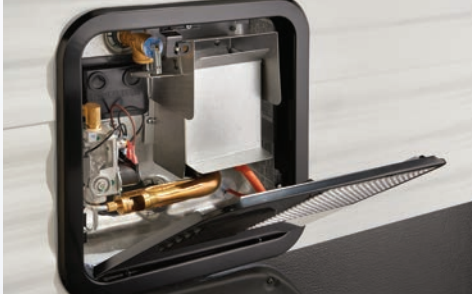

Six gallon gas/electric direct start ignition (DSI) water heater



Front and rear stabilizer jacks enhance stability. (Electric option shown)

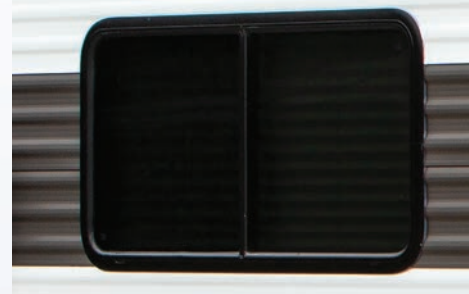

Tinted windows add style and reduce interior fading



Lionshead nitro-filled tires improve safety, tire life and fuel economy. Grey steel rims, Super Lube axles, ABS molded fender skirts – all standard.



Radius compartment doors are silicone sealed to protect from the elements



Reliable rack and pinion flush-floor slide system



Bright, energy efficient LED interior lighting



Back-up camera ready for safety and convenience



King Jack omni-directional HDTV antenna with built-in, long-range signal finder and WiFi prep

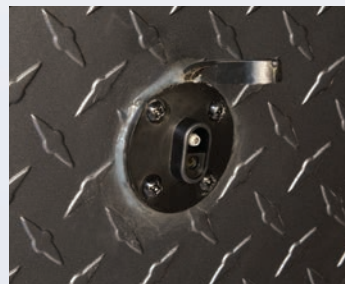

Prewired for solar power for extended stays and off-grid camping



Bathroom LED motion sensor light

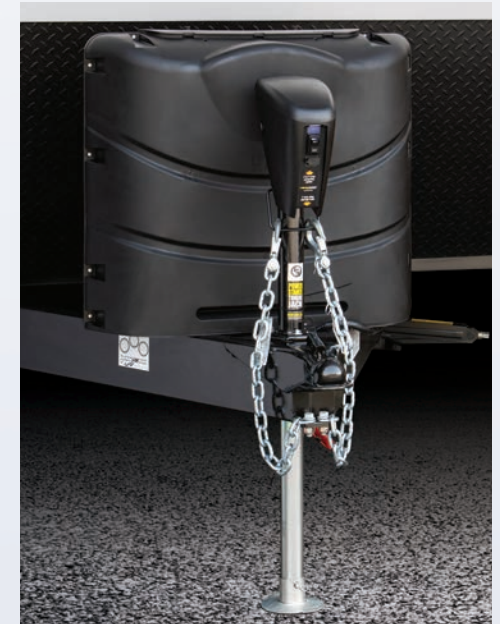

(2) 20 Lb. LP bottles with cover. (Optional lighted power jack with chain hooks shown)



## PUMA XLE TOY HAULERS

The **29TSS** Toy Hauler, shown with the Elite Package, comes equipped with stainless steel appliances including: an 11 cu. ft. 12V residential refrigerator, microwave, and 3-burner stove with a 17" oven, LED backlit controls, and a glass range cover. Standards also include night shades, a decorative backsplash, AM/FM Bluetooth stereo, exterior speakers, an electric awning, and an outside shower.

*Crank up the jams! The entertainment center with AM/FM Bluetooth stereo system has shoe and pet dish storage underneath to keep things tidy. TV shown is optional.*

## GET OUT THERE WHERE THE ACTION IS WITH PUMA XLE TOY HAULERS

*See Page 4 for Standard Features*

### 29TSS

This versatile garage area features roll-over sofas that convert to a sleeping area. The dinette table can be used indoors or out. The 7' 3" door opening accommodates larger toys. A zip screen ramp door lets fresh air in and keeps insects out.





## PUMA XLE TOY HAULER PACKAGES

### VALUE LEADER PACKAGE (Required)

- Tub Surround
- Bedspread with Pillows
- TV Antenna with Cable Hook-up
- Tinted Safety Glass Windows
- Super Lube Axles
- Front & Rear Stabilizer Jacks
- Beauflor Linoleum
- Bath Skylight
- LED Lighting Throughout
- Bedroom TV Hook-up
- WiFi Prep
- Solar Prep

### ELITE PACKAGE (Required)

- Electric Awning
- 17" Oven & Range Hood
- Stainless Steel Microwave
- AM/FM/Bluetooth Stereo
- 2 Exterior Speakers
- Outside Shower
- Spare Tire
- Front Diamond Plate
- 13,500 BTU Ducted A/C
- 6 Gal. Gas/Electric Water Heater
- Night Shades
- Aluminum Solid Steps
- 11 Cu. Ft. Residential Refrigerator

### ELECTRIC POWER PACKAGE (Optional)

- 4 Electric Stabilizer Jacks • 3500 lb Electric Tongue Jack

### PUMA XLE TOY HAULER HEIGHT INCLUDING OPTIONS (FROM FLOOR)

MODEL	ONE ELECTRIC BED	TWO ELECTRIC BEDS	HAPPIJAC	ENTRANCE AT DOOR	TO BOTTOM OF AC	TO CEILING
24 FBC	84"	75"	84"	86"	90.5"	91.5"
25 TFC	84"	75"	84"	86"	90.5"	91.5"
27 TSB	84"	75"	84"	86"	90.5"	91.5"
27 QBC	84"	75"	84"	86"	90.5"	91.5"
29 TSS	84"	75"	84"	86"	—	91.5"

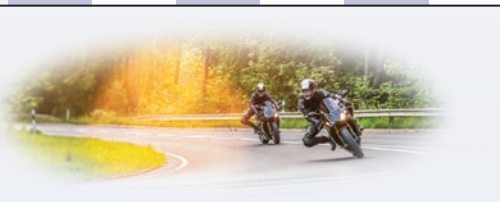

The Rear  
Patio Deck  
option extends  
living space and  
outdoor fun.

## PUMA XLE TOY HAULERS

### OPTIONS

#### OUTSIDE KITCHEN OPTION W/ GRIDDLE

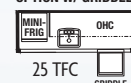

#### OUTSIDE KITCHEN OPTION W/ GRIDDLE

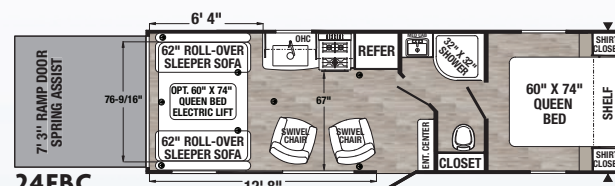
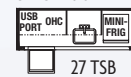

24FBC

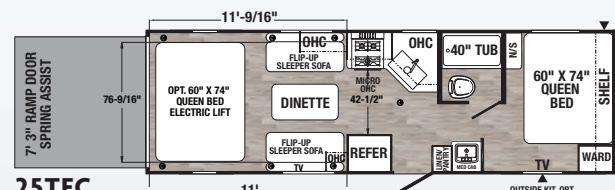

25TFC

Front queen bed is 60" x 70" with outside kitchen option.

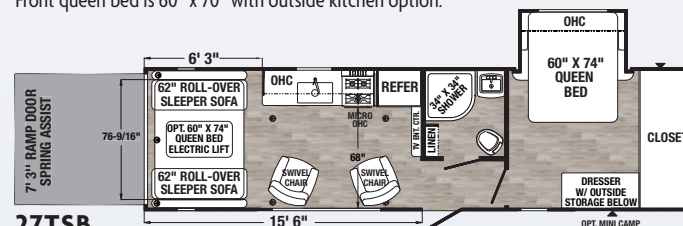

27TSB

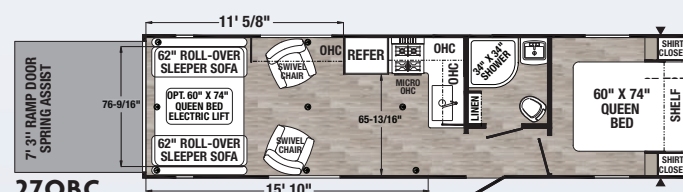

27QBC

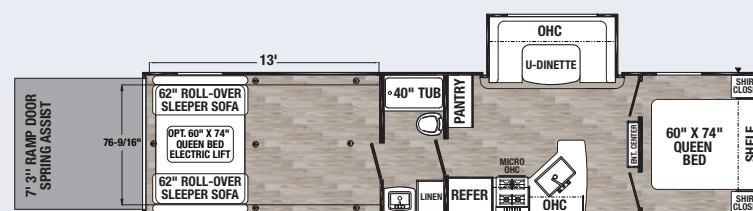

29TSS

## PUMA XLE TOY HAULERS

MODEL	24FBC	25TFC	27TSB	27QBC	29TSS
Hitch Weight (lbs)	775	745	1145	892	1235
Axle Weight (lbs)	5248	5354	6085	5716	6580
UVW (lbs)	6061	6137	7268	6646	7853
GVWR (lbs)	7775	8800	9995	9200	11435
Cargo Capacity (lbs)	1714	2663	2727	2554	3582
Exterior Length	29' 9"	29' 9"	33' 7"	34' 1"	37' 6"
Exterior Height w/AC	12' 2"	12' 2"	12' 2"	12' 2"	12' 2"
Exterior Width	96"	96"	96"	96"	96"
Fresh Water Cap. (gal)	43	43	43	43	43
Black Water Cap. (gal)	35	35	35	35	35
Grey Water Cap. (gal)	35	35	35	35	35
Tire Size (in)	15"	15"	15"	15"	15"
Awning Size (ft) OPT.	18'	14'	21'	19'	21'

Refer to back cover for chart definitions.

Check us out at: <https://palominorv.com/travel-trailers/puma-xle-lite>

Heavy-duty 5000 lb. D-ring tie-downs are anchored to the frame for secure travel with dovetail ramps for easy access. The cargo area can be configured to include: a double electric bed, a single electric bed or a Happi-Jac sofa with a single electric bed. TV is optional.





This optional outside kitchen has plenty of storage, both overhead and under the counter, a 3.2 cu. ft. refrigerator, a griddle, hot and cold running water, plus a handy USB wireless charging dock with expansion capabilities. (Select models)



This mini kitchen option includes a griddle, a 1.6 cu. ft. refrigerator, a removable sink, and handy storage drawer. (Select models)



# PUMA XLE LITE

TRAVEL TRAILERS AND TOY HAULERS

## OUTDOOR KITCHEN OPTIONS



The optional Micro kitchen has a pull-out griddle and a 1.6 cu. ft. refrigerator. (Select models)

**Puma XLE Lite by Palomino,**  
a Division of Forest River, Inc.  
2551 Century Drive • Goshen, IN 46528  
Check us out at:  
<https://palominorv.com/travel-trailers/puma-xle-lite>

## AWARD WINNING

Reliability • Quality  
Parts • Warranty  
Sales



**YOUR PUMA**  
**ULTRA LITE & XLE LITE DEALER**



## PRE-DELIVERY INSPECTION FACILITY

20,000 square feet of quality assurance. The bare essentials for a premium product. This state-of-the-art facility gives immediate daily feedback to production for quality assurance in every unit built.



## 24/7 EMERGENCY ROADSIDE ASSISTANCE WITH VEHICLE PURCHASE\*

TOWING  
JUMP-STARTS  
TIRE CHANGES  
FLUID DELIVERY  
LOCKOUT  
SERVICE

WINCH-OUT  
MOBILE MECHANIC  
TECHNICAL  
SUPPORT  
DEALER LOCATOR  
SERVICES



\*VALID FOR 1 YEAR FROM DATE OF PURCHASE



**Learn More**  
Scan this barcode using  
a QR Reader on your  
smart phone to learn  
more about Forest River.



**GVWR (Gross Vehicle Weight Rating)** - is the maximum permissible weight of the unit when fully loaded. It includes all weights, inclusive of all fluids, cargo, optional equipment and accessories. For safety and product performance do NOT exceed the GVWR.

**GAWR (Gross Axle Weight Rating)** - is the maximum permissible weight, including cargo, fluids, optional equipment and accessories that can be safely supported by a combination of all axles.

**UVW (Unloaded Vehicle Weight)\*** - is the typical weight of the unit as manufactured at the factory. It includes all weight at the unit's axle(s) and tongue or pin and LP Gas. The UVW does not include cargo, fresh potable water, additional optional equipment or dealer installed accessories.

\*Estimated Average based on standard build optional equipment.

**CCC (Cargo Carrying Capacity)\*\*** - is the amount of weight available for fresh potable water, cargo, additional optional equipment and accessories. CCC is equal to GVWR minus UVW. Available CCC should accommodate fresh potable water (8.3 lbs per gallon). Before filling the fresh water tank, empty the black and gray tanks to provide for more cargo capacity.

\*\*Estimated average based on standard build optional equipment.

Each Forest River RV is weighed at the manufacturing facility prior to shipping. A label identifying the unloaded vehicle weight of the actual unit and the cargo carrying capacity is applied to every Forest River RV prior to leaving our facilities. The load capacity of your unit is designated by weight, not by volume, so you cannot necessarily use all available space when loading your unit.

All information contained in this brochure is believed to be accurate at the time of publication. However, during the model year, it may be necessary to make revisions and Forest River, Inc. reserves the right to make all such changes without notice, including prices, colors, materials, equipment and specifications as well as the addition of new models and the discontinuance of models shown in this brochure. Therefore, please consult with your Forest River dealer and confirm the existence of any materials, design or specifications that are material to your purchase decision.  
©2021 Puma by Palomino a Division of Forest River, Inc., a Berkshire Hathaway company. All Rights Reserved. 3/21